

SENTAR II

**6, 12, 18, 24, 30 AND 36 STATIONS
OUTDOOR/INDOOR**



The Sentar II™ has long been noted as the “workhorse” of irrigation controllers. It offers advanced control features for a fraction of the cost of similar models. Designed with the irrigation manager in mind, the Sentar II protects landscapes by offering: rain sensing, flow sensing, and cycle and soak scheduling on any of 4 fully independent programs.

KEY FEATURES & BENEFITS

FOUR INDEPENDENT PROGRAMS

Five start times for a total of 20 possible start times per day

COMMERCIAL-GRADE, LOCKABLE STEEL & STAINLESS STEEL CABINETS AND PEDESTALS

For vandal resistance and longer service life

CYCLE AND SOAK

To eliminate runoff and conserve water

ODD/EVEN-DAY CALENDAR WITH DAY EXCLUSION; SEVEN-DAY CALENDAR

To match water restrictions and varied plant water requirements

NON-VOLATILE MEMORY

Retains all program data indefinitely during outages or shutdowns.

PROGRAMMABLE OVERLAP PROTECTION

Allows programs to run one after the other (stack mode) or at the same time (no stack mode).

BUILT-IN REMOTE JACK

For use with Irritrol Pro Max™ remotes and optional permanent mount receiver

ADDED FEATURES

- Flow sensing allows for total flow control and break detection (requires flow sensor)
- Watering time(s) for each station can be set from 1 minute to 9 hrs 59 mins in 1 minute increments
- Quick Stations allow for rapid programming of a block of stations with the same watering time
- Water days for each program may be based on seven day week or a skip-by-day routine allowing a program to skip from 1 to 30 days between watering
- Programmable rain shut down allows the selection of the number of days (1 to 7) the controller will remain in rain shut down before restoring automatic watering.
- A "real time" clock holds the actual time during power outages without batteries
- The Review feature brings all the information for a given program(s) to the displays with simple push of the Review Button.
- Multiple displays provide a truly simple way of programming and information recall
- Manually activated program cycle to run a program independent of its programmed start time and water days
- Automatic field wire fault detection enables the controller to sense a short circuit in the field wire and instantly turn off that station, report the fault and move to the next programmed station. No fuses or reset button to be concerned with.
- Manual Rain Switch (auto-off) turns off all stations without disturbing the program(s).
- Heavy-duty 18-gauge steel enclosure with powder coated finish. Also available in Stainless Steel.
- Extra heavy-duty lightning and surge protected models available for areas where lightning is a concern
- Water budgeting by increasing or decreasing station run times in 1% increments from 0% to 300% by program
- Limited five-year warranty

ENCLOSURES

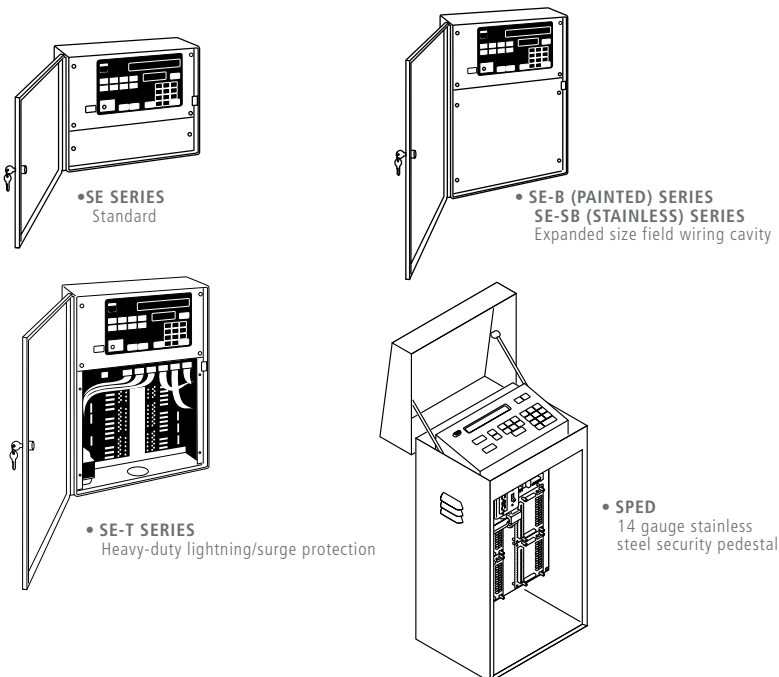

OPERATING SPECIFICATIONS

- Programmable master valve and pump allows the master valve or pump to be assign to any program.
- Programmable time delay between stations (from 1 to 256 seconds) permits slow-closing valves to fully close.
- Programmable security code allows entry of a 1-4 digit number as a security code to prevent access by unauthorized personnel.
- Programmable rain sensor can be assigned on a per program basis.
- Programmable alarm to enable or disable an audible alert in the event of a field wire fault.

ELECTRICAL SPECIFICATIONS

- Input power required: 105-130V ac, 50/60 Hz, 0.5 amp maximum, 0.1 amp idle
- Output power: 24V ac 1.5 amps maximum total output (36VA) 1 amp per station or master valve
- UL, CUL and FCC Approved

DIMENSIONS

- **SE Series:** 10" x 13" x 4 1/2"
- **SE-B & SB Series:** 17 1/2" x 13" x 4 1/2"
- **RMPED-1:** 16" x 34" x 16"

OPTIONAL ACCESSORIES

- PMRKIT: Permanent mount receiver kit for use with Pro Max remote
- RMPED-1: Outdoor pedestal

SPECIFYING INFORMATION

MODEL	# OF STATIONS	OPTIONAL ENCLOSURE TYPE	OPTIONAL SURGE PROTECTION
RME6SE	6	B, SB, SPED	T
RME12SE	12	B, SB, SPED	T
RME18SE	18	B, SB, SPED	T
RME24SE	24	B, SB, SPED	T
RME30SE	30	B, SB, SPED	T
RME36SE	36	B, SB, SPED	T

B = Large painted wall mount

SB = Large stainless wall mount

SPED = Stainless steel large enclosure pedestal

EXAMPLE: A 36-station Sentar II with a large stainless wall mount option and surge protection would be specified as **RME36SE-SB-T**

We reserve the right to improve our products and make changes in the specifications and designs without notice and without incurring obligation. Products depicted in this brochure are for demonstration purposes only. Actual products offered for sale may vary in design and features.